

LENGHT OVERALL : 109.80 M.  
 LENGHT BP : 99.20 M.  
 DEPTH : 7.50 M.  
 BREADTH : 14.00 M.  
 DRAUGHT : 5.933M.

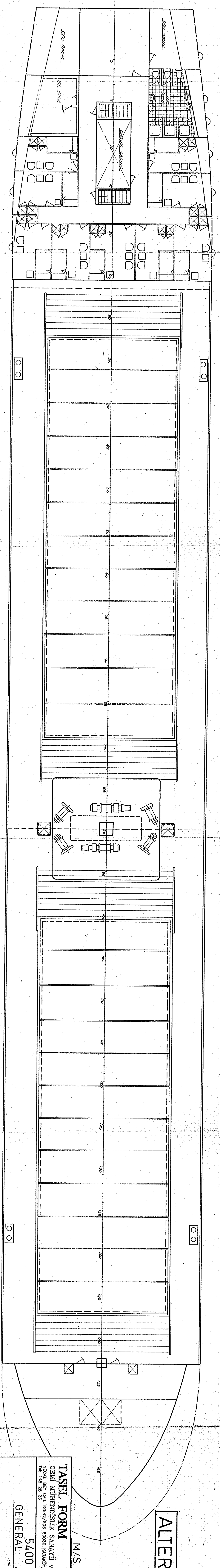
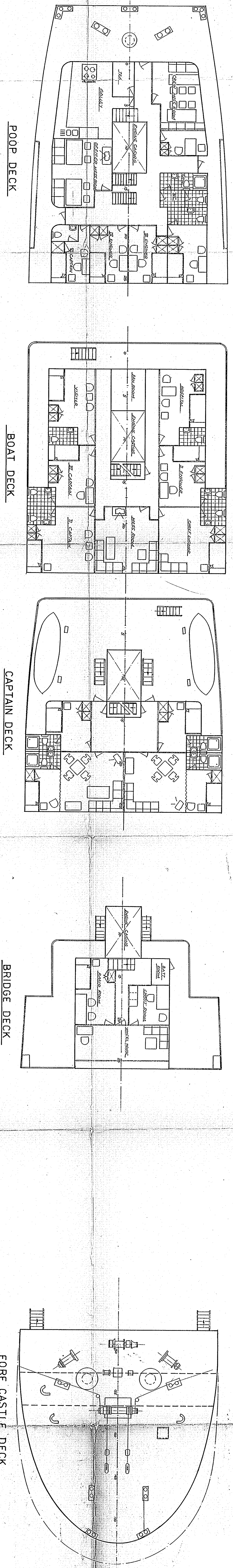

**ALTERATION PLAN**

M/S TAYFUN BAYRAKTAR

TASEL FORM

5400 DWT  
GENERAL ARRANGEMENT

DESIGNED BY	DATE	OWNER
CHECKED BY	3 / 11 / 99Z	
SCALE		
1/100		
CLASS		
ABS		
BUILD. NR.		
6		
YARD		
GISAN S.Y.		